













- 1 
- 2 
- 3 
- 4 
- 5 
- 6 
- 7 
- 8 
- 11 
- 12 
- 21 
- 23 
- 42 

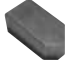

**RF11 / RF12**

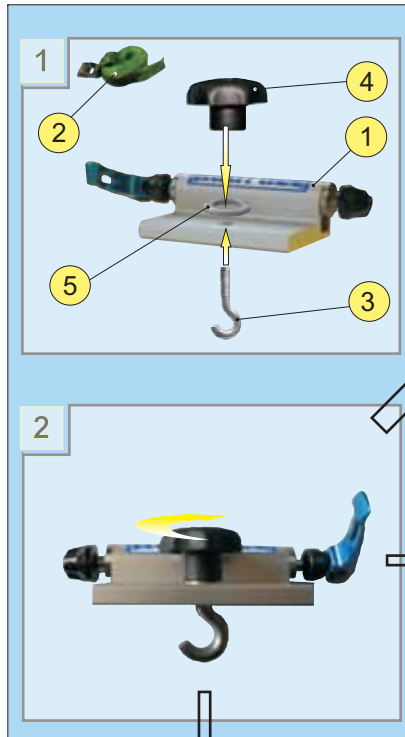

- Citroën XSARA Picasso
- Chrysler Voyager
- Fiat Multipla
- Ford Galaxy
- Ford Tourneo Connect
- Hyundai Trajet
- Mazda Premacy \*(144cm)
- Nissan Almera Tino \*(134cm)
- Renault Espace
- Renault Scénic bis 05.03
- Seat Alhambra
- Toyota Avensis Verso
- Toyota Previa
- VW Sharan
- VW T5 Combi

**2**

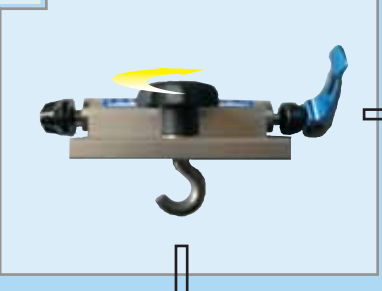

**RF15** Peugeot 307 SW

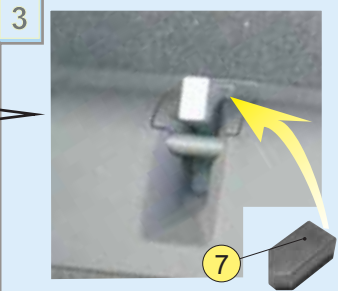

**RF16** VW Touran

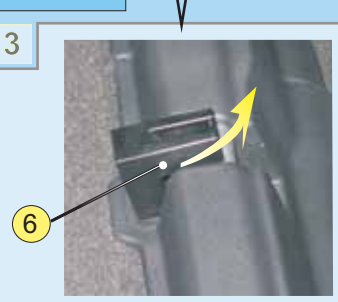

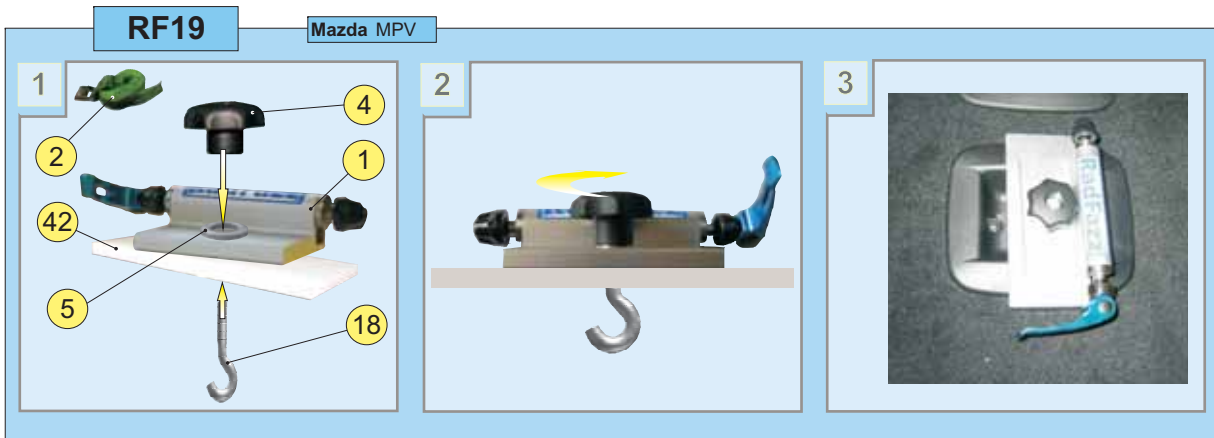
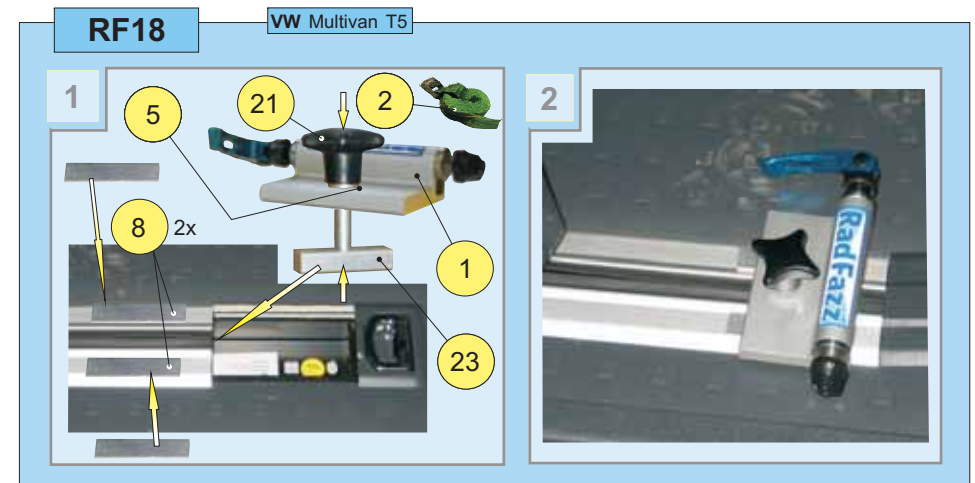
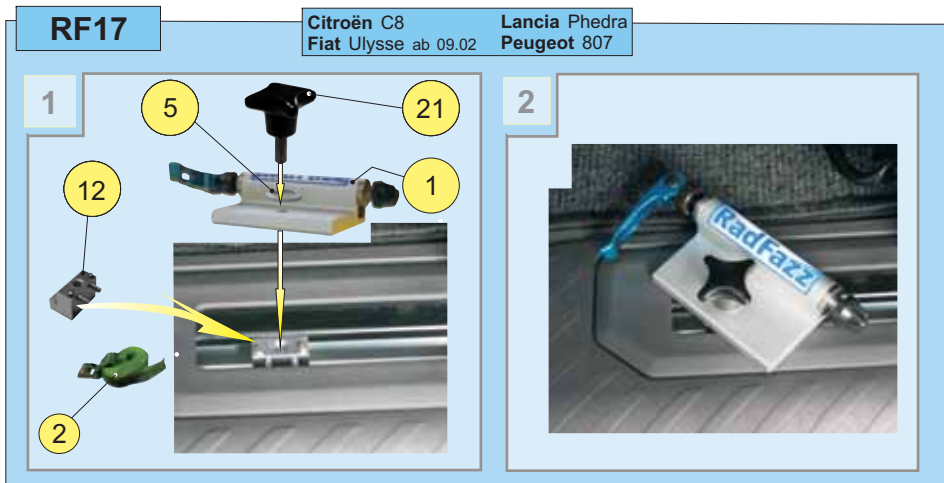

**Sicherheitshinweis!** Der Hinterbau des Fahrrades muß mit **2** gesichert werden.  
Den festen Sitz der gesamten Einheit nach einigen Kilometern überprüfen und gegebenenfalls nach befestigen.

